

GMZNAUX1



Purpose

The SoundGate GMZNAUX1 lets you connect a Zune™ digital media player directly to the factory radio in the GM vehicles listed below. The GMZNAUX1 supplies power, charges your Zune device, and allows for remote control of all Zune device functions (remote sold separately).



Features

The SoundGate GMZNAUX1 utilizes sophisticated microprocessor control, ultra-reliable surface-mount construction, and advanced software design to flawlessly integrate with factory audio systems. Your Zune device's audio can be selected from your factory radio's controls.

The GMZNAUX1 works in the following vehicles:

BUICK	CHEVEROLET (CONTINUED)	OLDSMOBILE
2004-06 Rainier	2003-07 Silverado Classic*	2003-04 Alero with RDS radio only
2004-06 Rendezvous	2004-06 SSR	2003-04 Bravada
2003 Rendezvous with cassette/CD or in-dash 6-disc receiver only	2003-06 Suburban*	2003-04 Silhouette
	2003-06 Tahoe*	PONTIAC
	2003-07 Trailblazer	2004-05 Aztek
	2003-05 Venture	2003 Aztek with RDS radio only
		2003-05 Grand Am with RDS radio only
CADILLAC	GMC	
2004-06 Escalade	2005-07 Canyon	2004-07 Grand Prix
2003 Escalade with cassette/CD or Navigation radios only	2003-06 Denali/Denali XL*	2003-07 Montana
	2003-07 Envoy	2004-05 Sunfire with RDS radio only
	2004 S-15/Sonoma*	2003 Sunfire with MP3 radio only
CHEVROLET	2003-07 Savana Van with in-dash 6-disc receiver only	
2003-06 Avalanche	2003-07 Sierra/Sierra Denali Classic*	SAAB
2004 Blazer*	2003-07 Yukon/Yukon XL*	2005-07 9-7X
2003-05 Cavalier*		
2005-07 Colorado		
2005-06 Equinox		
2003-07 Express Van with in-dash 6-disc receiver only		
	HUMMER	
2003-05 Impala	2003-07 H2	
2003 Malibu	2006-07 H3	
2003-05 Monte Carlo	ISUZU	
2004 S-10*	2004-08 Ascender	

Simple-fi.™

www.soundgate.com

Rev 20080404

If you experience problems, call SoundGate Technical Support at +1-800-256-0808, or email us at sgtech@soundgate.com.

WARNING

DO NOT DISASSEMBLE OR ALTER

Doing so may result in an accident, fire, or electric shock.

Do not block your view

Do not mount product or any added audio/video equipment where it can block your view through the windshield or block your view of dashboard indicators and displays.

Do not block safety devices

Do not mount product or any added audio/video equipment where it can obstruct the operation of any safety device, such as the airbag.

Distraction warning

Do not allow product or any added audio/video equipment to distract you while you are driving.

BEFORE WIRING, DISCONNECT THE CABLE FROM THE NEGATIVE BATTERY TERMINAL

Before starting any installation work, wait 90 seconds after turning the ignition switch to the LOCK position and disconnecting the negative (-) terminal from the battery. The supplemental restraint system (SRS), or airbag(s) is equipped with a backup power source. If installation work is started less than 90 seconds after disconnection of the negative (-) battery terminal, the SRS may deploy. When the negative (-) terminal cable is disconnected from the battery, the clock and audio systems' memory may be erased. Before starting installation work, make a record of the clock and audio systems' memory settings. When installation is complete, reset the clock and audio systems to their previous settings. Power tilt, power telescopic steering column, power seats, power mirrors, power shoulder belt anchorage, and other power accessories may or may not be equipped with a memory function; consider keeping a record of these settings as well.

When installation is complete, readjust the features to their previous settings.

Never use a backup power supply (such as another battery) during installation work in an attempt to avoid losing these memory settings.

CAUTION

DO NOT ALLOW CABLES TO BECOME ENTANGLED IN SURROUNDING OBJECTS

Cables or wiring that obstruct or get caught on places such as the steering wheel, shift lever, brake pedals, etc. can be extremely hazardous.

DO NOT INSTALL IN LOCATIONS WITH HIGH MOISTURE OR DUST

Moisture or dust may result in product failure.

HAVE THE WIRING AND INSTALLATION DONE BY EXPERTS

The wiring and installation of this product requires special technical skills and experience.

USE ONLY SPECIFIED ACCESSORY PARTS

Use of other than specified parts may damage product internally.

FOLLOW THE OPERATIONAL AND INSTALLATION MANUALS.

YOU SHOULD READ AND FAMILIARIZE YOURSELF THOROUGHLY WITH THE FOLLOWING INFORMATION PRIOR TO INSTALLING AND USING THIS UNIT. IN ADDITION, YOU MUST CAREFULLY READ AND FOLLOW THE INSTALLATION SCHEMATICS AND INSTRUCTIONS FOR THE PRODUCT AND THE VEHICLE IN WHICH IT IS BEING INSTALLED. FAILURE TO FOLLOW INSTALLATION INSTRUCTIONS MAY DAMAGE THE PRODUCT AND THE VEHICLE, WILL VOID THE PRODUCT WARRANTY, AND MAY VOID THE VEHICLE WARRANTY.

TROUBLESHOOTING

Should this product fail to operate properly, please contact your Dealer or SoundGate Technical Support via email at sgtech@soundgate.com or via phone at +1-800-256-0808.

GMZNAUX1 Overview

RCA component A/V outputs. Connect the audio outputs to the matching locations of the GMZNAUX1 components on the next page.

Yellow = Video
Red = Audio Right
White = Audio Left

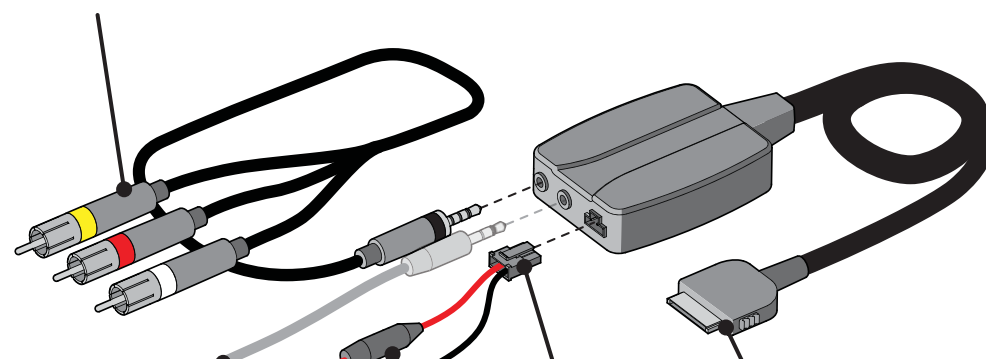

Optional remote control (available separately). Allows full control of a connected Zune device's functions

Power connector. Connect black wire to bare-metal chassis. Connect red wire to a +12V switched (ignition) power source.

Inline fuse. The red wire of the power connector is fused to protect your Zune device and vehicle systems. The red wire requires a 12V, 1500mA fuse.

Connect the RCA Left (white) and Right (red) audio cables (from the component-set on page 2) to the GMZNAUX1 module.

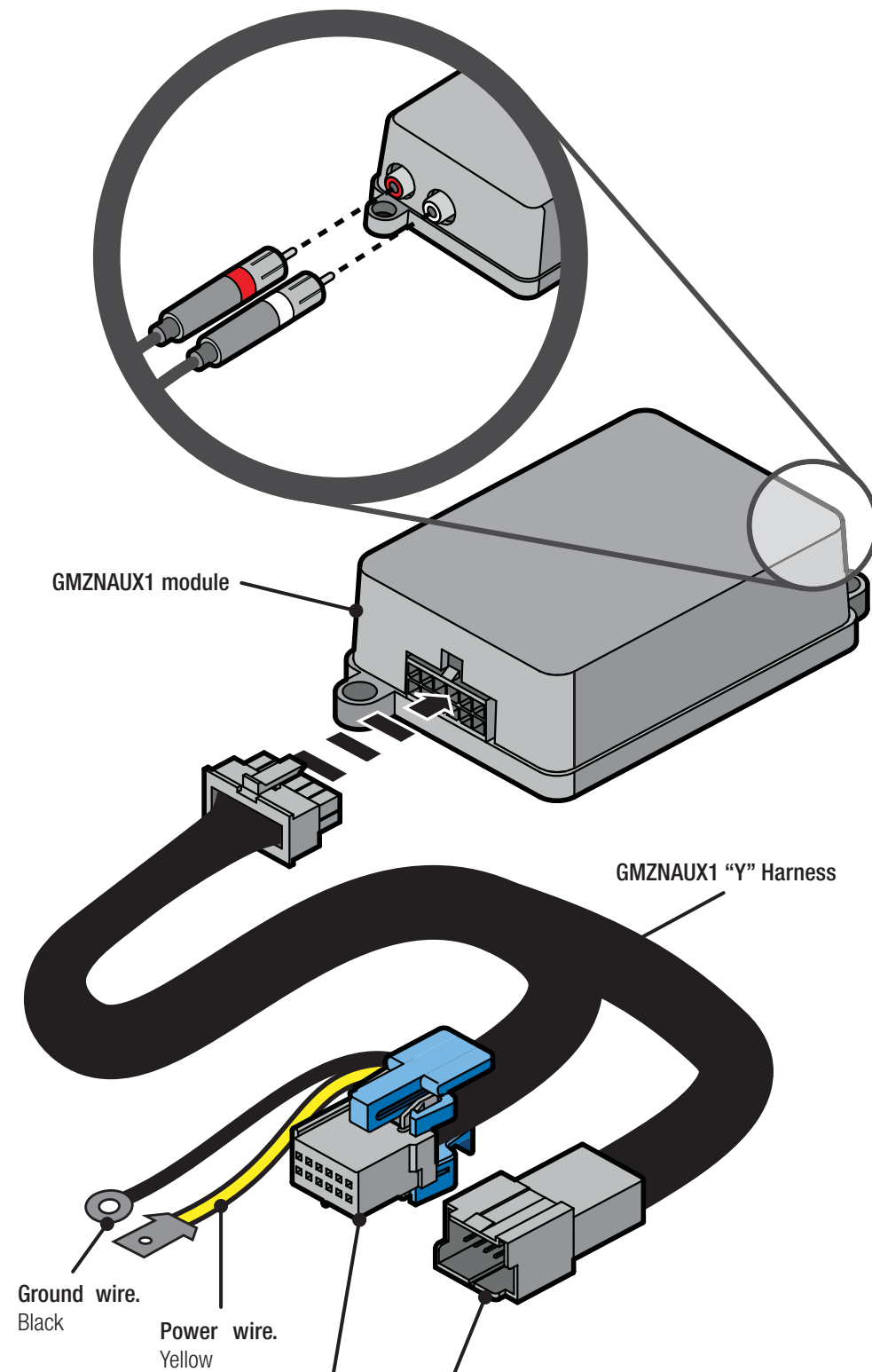

Ground wire.
Black

Power wire.
Yellow

Male and Female connectors. Disconnect the existing 12-pin connector on the rear of the factory radio. Replace this connector with the 12-pin male connector from the GMZNAUX1 "Y" harness. Plug the connector you disconnected from the rear of the radio into the female connector on the GMZNAUX1 "Y" harness.

IMPORTANT

On full-sized SUV's and Pickups, **DO NOT use the metal brace behind the radio or the ground in the factory radio harness for grounding the GMZNAUX1.** These are typically very poor grounding points. In these vehicles we recommend connecting the ground to the left kick panel structure. On all other vehicles, use a multimeter to find the best grounding point (see page 5, step 3).

Before you begin:

1. Turn the ignition off.
 2. Ensure the factory radio is turned off.
 3. Set the internal jumper inside the GMZNAUX1 module according to your factory radio's configuration (see instructions and diagram below). To remove the module cover, squeeze the sides together and pull the cover away from the module's base. The internal jumper is located on the circuit board near the RCA connectors (see picture for locational details).
- For vehicles with factory XM ONLY (no CD changer), set the jumper to **CHANGER**.
 - For vehicles with other factory radio configurations (factory CD/DVD changer only, factory CD changer and factory XM, factory in-dash navigation, etc), set the jumper to **XM**.

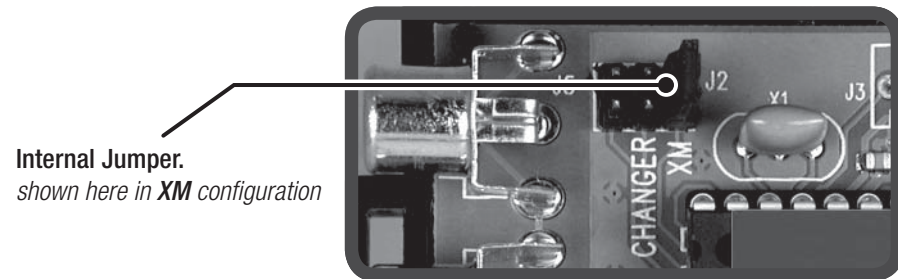

Installing the Jumper.

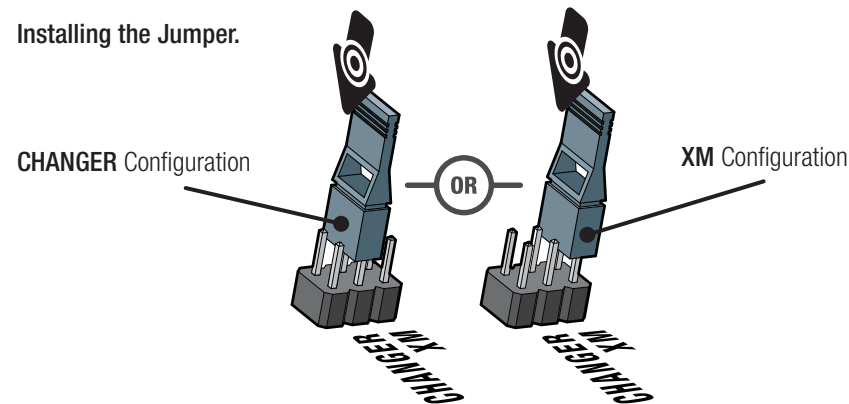

Installation

STEP 1 Gain access to the factory radio's rear panel. The GMZNAUX1 connects directly to the rear panel of the factory radio. Full or partial disassembly of the dash will be necessary. If you are unsure of this procedure, please consult a factory service manual or have the work performed by a mobile electronics specialist. Pay special attention to warnings or instructions regarding working near airbags, other safety devices, or security systems.

Installation

STEP 2 Connect the GMZNAUX1 to the factory radio. Disconnect the existing 12-pin connector on the rear of the factory radio. Replace this connector with the 12-pin male connector from the GMZNAUX1 "Y" harness.. Plug the connector you disconnected from the rear of the radio into the female connector on the GMZNAUX1 "Y" harness. Connect the GMZNAUX1 "Y" harness to the GMZNAUX1 module as shown on page 3.

STEP 3 Connect the GMZNAUX1 "Y" harness power and ground. Connect the black wire on the GMZNAUX1 "Y" harness to a clean, bare-metal chassis ground (please see **IMPORTANT** note at the top of page 4). When in doubt, measure the resistance between potential grounding points and the vehicle battery using a multimeter. Choose a grounding point with equivalent resistance as other grounded components in the audio system. Connect the yellow wire to a constant +12V power source (vehicle battery). We **DO NOT** recommend the +12V constant in the factory radio harness due to the possibility of excessive voltage drop during vehicle starting.

STEP 4 Assemble the components shown on page 2 and connect them to the GMZNAUX1 module. Use the diagrams on pages 2 and 3 to assemble the components that will connect to and control your Zune device. Use the instructions above from step 3 to connect the black (ground) wire of the power connector; connect the red wire to a +12V switched (ignition) power source. The red wire of the power connector requires a 12V, 1500mA inline fuse. MAKE CERTAIN THAT REPLACEMENT FUSES MATCH THESE SPECIFICATIONS.

STEP 5 Mount all components. Mount the GMZNAUX1 module behind or under the dash (mounting hardware not included). Be careful not to drill into wiring or vehicle mechanisms. You are solely responsible for securely fastening the GMZNAUX1 in your vehicle. Make certain that wires and cables cannot be damaged by screws, clips, or sharp, exposed pieces of metal. Ensure that the Zune dock connector is left in a convenient place for connection to your Zune device. Plug the Zune dock connector in straight. Do not insert the connector at an angle or wiggle the connector during insertion.

Operation

Controlling your Zune device

The GMZNAUX1 will not provide control of your Zune device unless you attach the optional remote, which is available separately. Please visit www.soundgate.com or your local mobile audio dealer for details on the GMZNAUX1 remote's availability.

Activating the GMZNAUX1

Depending on your factory radio's configuration, activate/deactivate the GMZNAUX1 by following the instructions shown in the chart below.

	FACTORY XM ONLY	FACTORY CD/DVD CHANGER ONLY	FACTORY XM AND CHANGER
To Activate GMZNAUX1:	Press CD button.	Press BAND button.	Select XM , then press SEEK▲ 3 times, then SEEK▼ once quickly.
To Deactivate GMZNAUX1:	Press any other source button.	Press any other source button.	Press SEEK▲ once, then SEEK▼ once.

See page 6 for important troubleshooting information.

TROUBLESHOOTING

If the factory radio does not recognize the GMZNAUX1...

In some instances the factory radio may not immediately recognize the GMZNAUX1. If this happens, follow the steps below.

1. If the factory radio cannot access the GMZNAUX1 with the radio turned on, disconnect the 12-pin male connector from the rear panel of the radio for a few seconds, then reinsert the connector securely. Wait 10-15 seconds, then press the **BAND** button to activate the GMZNAUX1. If the radio does not recognize the GMZNAUX1, proceed to the next step.
2. Disconnect the main 24-pin connector from the rear panel of the radio for 5-10 seconds, then reinsert the connector securely. Wait 10-15 seconds, then press the **BAND** button to activate the GMZNAUX1.
3. If you are connecting the GMZNAUX1 to a factory in-dash navigation system or 6-CD receiver, the internal jumper on the inside of the GMZNAUX1 module must be set to **XM** (see page 4 for instructions). Activate the GMZNAUX1 by pressing **SEEK▲** three times, then **SEEK▼** once quickly. To deactivate the GMZNAUX1 press **SEEK▲** once, then **SEEK▼** once.



Why SoundGate Dealers have the edge...

The technologies used in today's vehicles are as sophisticated as any laptop computer. At SoundGate we believe these new technologies are full of opportunities for mobile electronic dealers across the nation. We make it a high priority to not only research these new systems, but to understand them and their impact on the aftermarket car audio industry. Armed with this knowledge, we are well equipped to help you integrate new components into these systems with our innovative, high-performance interfaces and unparalleled technical support.

Ask your autosound specialist about these other exciting SoundGate products...

- Auxiliary Input Interfaces and Docking Stations which allow you to input audio from MP3 Players, DVD/Video, Satellite Radio, and more to OEM and aftermarket car audio systems
- High-performance Radio Replacement
- Interfaces for seamlessly integrating new receivers or CD players into OEM audio systems
- Competition-Grade Interfaces for adding amplifiers
- Remote Audio Control Interfaces that let you control aftermarket receivers and CD players from your factory rear seat, or steering-wheel mounted audio controls.
- And many others!

Simple-fi.™

www.soundgate.com

Zune™ and the Zune™ logo are trademarks of the Microsoft group of companies.

Copyright© 2004-2008 SoundGate®. All Rights Reserved. SoundGate® is a registered trademark of Stillwater Designs, Inc. All other trademarks are the property of their respective owners.