

FDPD4



SoundGate®

Purpose

The SoundGate FDPD4 lets you connect an iPod® digital media player directly to your factory radio in the Ford Corporation vehicles listed below. The FDPD4 charges your iPod device and allows for control of iPod device functions through the factory radio controls.



Features

The SoundGate FDPD4 utilizes sophisticated microprocessor control, ultra-reliable surface-mount construction, and advanced software design to flawlessly integrate with Ford Corporation audio systems. Utilized with the included SoundGate CORE™ product, the FDPD4 will enable control of your Apple iPod device through the controls of the factory radio.

The FDPD4 works in the following vehicles:

FORD

Escape	2008
Edge	2007–2008
Expedition/EL	2007–2008
Explorer/Sport Trac	2006–2008
Five Hundred	2005–2007
Focus	2005–2007
Freestar	2006–2007
Freestyle	2005–2007
Fusion	2006–2008
F-Series (New Body Style)	2005–2008
Mustang	2005–2008
Ranger	2006–2008
Taurus/Taurus X	2008

LINCOLN

Mark LT	2006–2008
MKX	2007–2008
MKZ	2007–2008
Navigator	2005–2008
Zephyr	2006

MERCURY

Mariner/Hybrid	2008
Milan	2006–2008
Monterey	2006–2008
Mountaineer	2007–2008
Sable	2008

Note: Installation of this device will replace one of the following radio functions if present:

Rear-Seat DVD Mode

Satellite Radio

Standard systems must have an AUX button.

Navigation units will use the touch-screen source selection.

Please visit www.soundgate.com for the most current compatibility information.

Simple-fi.®

If you experience problems, call SoundGate Technical Support at 800-256-0808, or email us at support@soundgate.com.

www.soundgate.com

Rev 20090310

Before You Begin



WARNING

DO NOT DISASSEMBLE OR ALTER

Doing so may result in an accident, fire, or electric shock.

Do not block your view

Do not mount product or any added audio/video equipment where it can block your view through the windshield or block your view of dashboard indicators and displays.

Do not block safety devices

Do not mount product or any added audio/video equipment where it can obstruct the operation of any safety device, such as the airbag.

Distraction warning

Do not allow product or any added audio/video equipment to distract you while you are driving.

BEFORE WIRING, DISCONNECT THE CABLE FROM THE NEGATIVE BATTERY TERMINAL

Before starting any installation work, wait 90 seconds after turning the ignition switch to the LOCK position and disconnecting the negative (-) terminal from the battery. The supplemental restraint system (SRS), or airbag(s) is equipped with a backup power source. If installation work is started less than 90 seconds after disconnection of the negative (-) battery terminal, the SRS may deploy. When the negative (-) terminal cable is disconnected from the battery, the clock and audio systems' memory may be erased. Before starting installation work, make a record of the clock and audio systems' memory settings. When installation is complete, reset the clock and audio systems to their previous settings. Power tilt, power telescopic steering column, power seats, power mirrors, power shoulder belt anchorage, and other power accessories may or may not be equipped with a memory function; consider keeping a record of these settings as well.

When installation is complete, readjust the features to their previous settings.

Never use a backup power supply (such as another battery) during installation work in an attempt to avoid losing these memory settings.



CAUTION

DO NOT ALLOW CABLES TO BECOME ENTANGLED IN SURROUNDING OBJECTS

Cables or wiring that obstruct or get caught on places such as the steering wheel, shift lever, brake pedals, etc. can be extremely hazardous.

DO NOT INSTALL IN LOCATIONS WITH HIGH MOISTURE OR DUST

Moisture or dust may result in product failure.

HAVE THE WIRING AND INSTALLATION DONE BY EXPERTS

The wiring and installation of this product requires special technical skills and experience.

USE ONLY SPECIFIED ACCESSORY PARTS

Use of other than specified parts may damage product internally.

FOLLOW THE OPERATIONAL AND INSTALLATION MANUALS.

YOU SHOULD READ AND FAMILIARIZE YOURSELF THOROUGHLY WITH THE FOLLOWING INFORMATION PRIOR TO INSTALLING AND USING THIS UNIT. IN ADDITION, YOU MUST CAREFULLY READ AND FOLLOW THE INSTALLATION SCHEMATICS AND INSTRUCTIONS FOR THE PRODUCT AND THE VEHICLE IN WHICH IT IS BEING INSTALLED. FAILURE TO FOLLOW INSTALLATION INSTRUCTIONS MAY DAMAGE THE PRODUCT AND THE VEHICLE, WILL VOID THE PRODUCT WARRANTY, AND MAY VOID THE VEHICLE WARRANTY.

CHECK YOUR LOCAL LAWS

Some States/Provinces or other governmental jurisdictions (such as cities) may have laws that prohibit the operation of a video screen within the sight of the driver. If you have purchased such a product, you should use the product only in locations where it is legal to do so, and if you do use the product, set up the screen so it is only visible to passengers.

TROUBLESHOOTING

Should this product fail to operate properly, please contact your Dealer or SoundGate Technical Support at 800-256-0808.

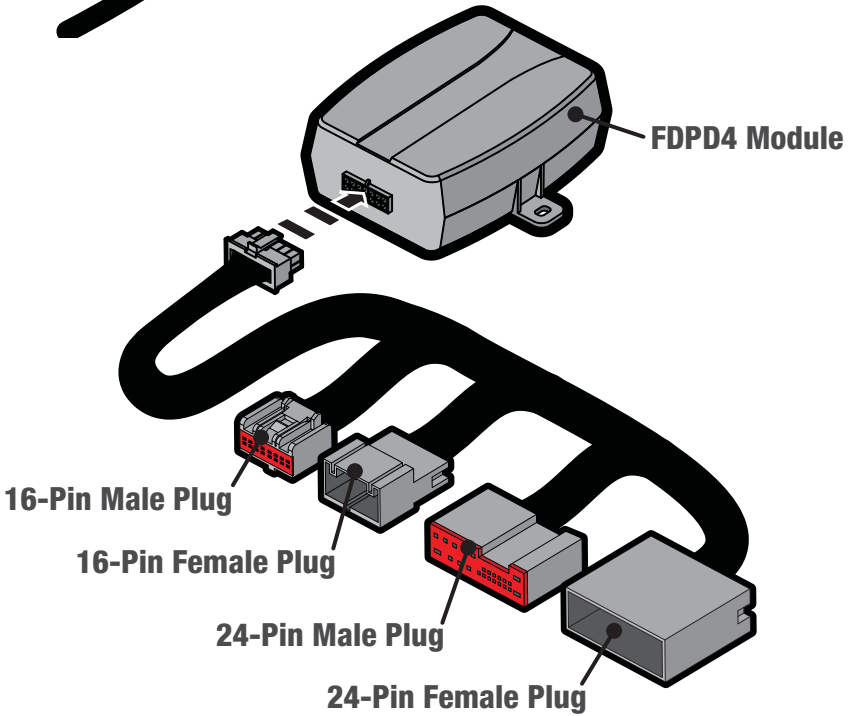
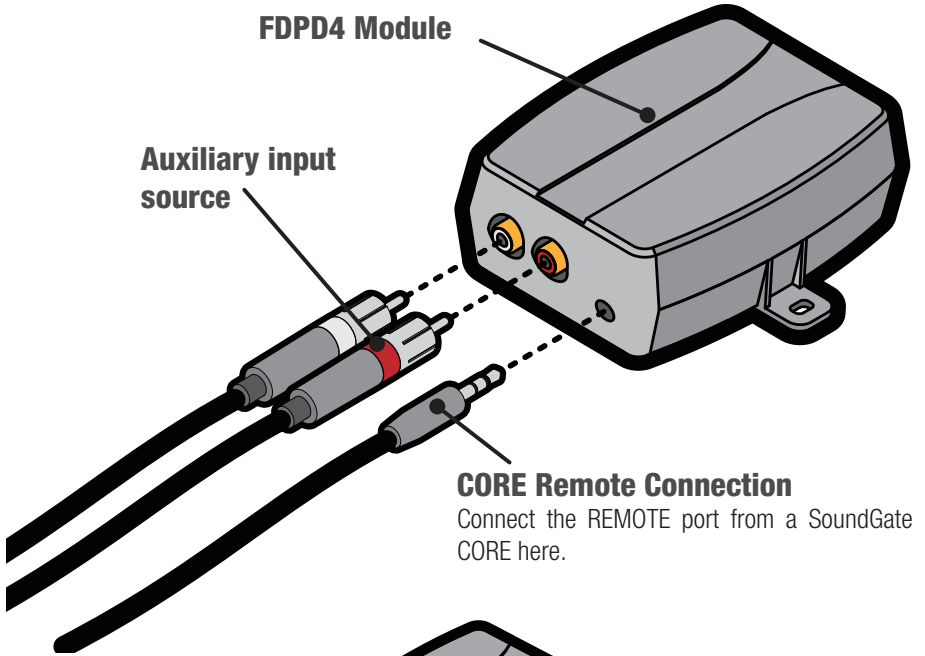

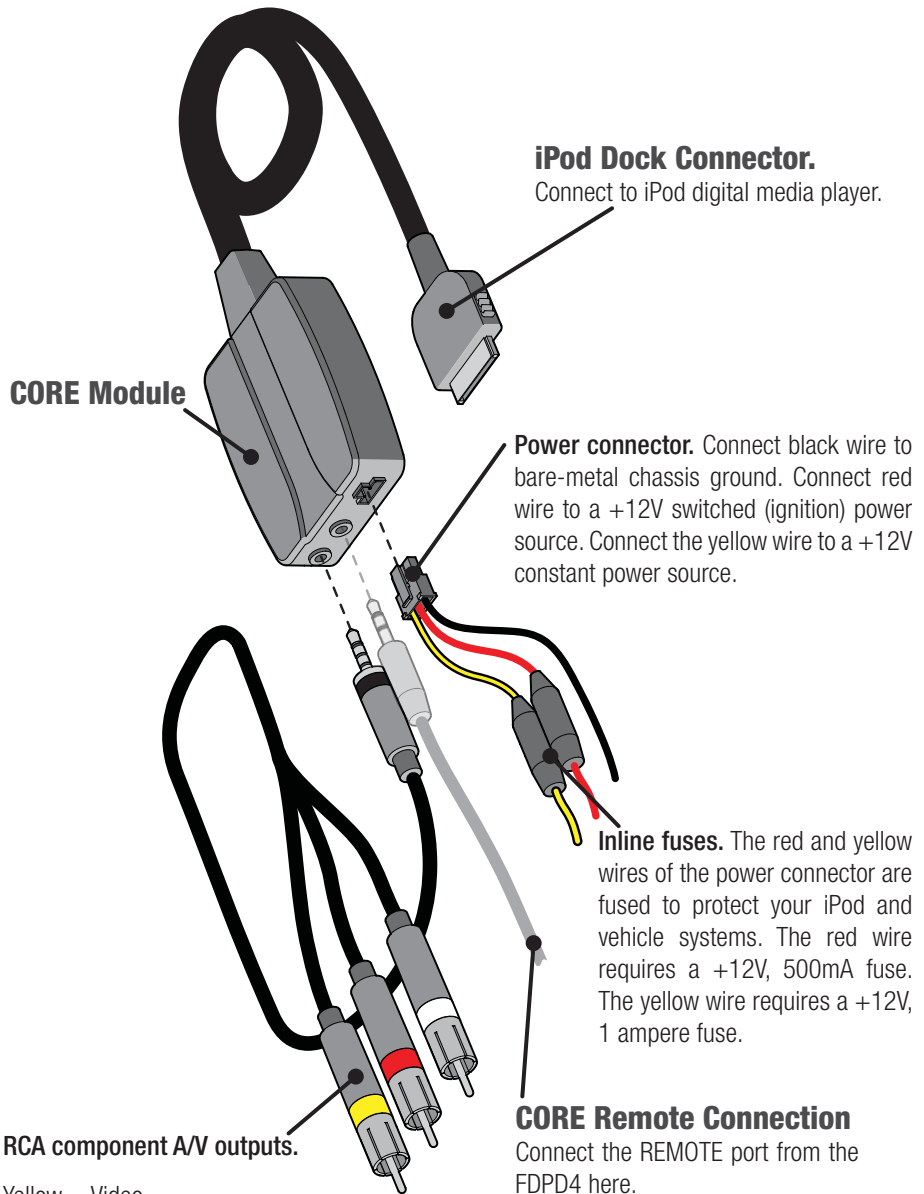

iPod Dock Connector.

Connect to iPod digital media player.

CORE Module

Power connector. Connect black wire to bare-metal chassis ground. Connect red wire to a +12V switched (ignition) power source. Connect the yellow wire to a +12V constant power source.

Inline fuses. The red and yellow wires of the power connector are fused to protect your iPod and vehicle systems. The red wire requires a +12V, 500mA fuse. The yellow wire requires a +12V, 1 ampere fuse.

RCA component A/V outputs.

Yellow = Video

Red = Audio Right

White = Audio Left.

Connect these to the audio inputs of the FDPD4 Module.

CORE Remote Connection

Connect the REMOTE port from the FDPD4 here.

BEFORE YOU BEGIN:

1. Turn the ignition off.
2. Ensure the factory radio is turned off

Installation**IMPORTANT**

The FDPD4 has two emulation modes that are selected by a jumper labeled **SW1** on the circuit board. When the jumper is on, the FDPD4 will emulate and replace the factory satellite radio. When the jumper is off, the FDPD4 will emulate and replace the factory rear-seat DVD. This will allow you to maintain as many of the factory options as possible. Each emulation mode will offer different functionality with your iPod device. Please see the table on page 7 for details.

STEP**1**

Gain access to the factory radio's rear panel. The FDPD4 connects directly to the rear panel of the factory radio. Full or partial disassembly of the dash will be necessary. If you are unsure of this procedure, please consult a factory service manual or have the work performed by a mobile electronics specialist. Pay special attention to warnings or instructions regarding working near airbags, other safety devices, or security systems.

STEP**2**

Connect the appropriate FDPD4 harnesses to the factory radio. The FDPD4 comes with a wiring harness that is necessary for functionality. Disconnect the factory radio's 24-pin and 16-pin connections. Replace these with the 24-pin and 16-pin male plugs of the FDPD4 wiring harness. Connect the remaining 24-pin and 16-pin female plugs to the disconnected factory plugs.

STEP

3

Connect your SoundGate CORE. The SoundGate CORE will allow you to control the functions of your iPod device through the controls of your factory radio. Connect the included A/V breakout cable to the **A/V OUT** jack on the SoundGate Core. Plug the left and right RCA audio connectors into the audio inputs of the FDPD4 Module. If you have an aftermarket DVD player or video receiver, plug the yellow composite RCA video connector into the aftermarket device's video input. Connect a 1/8" patch cable from the CORE remote connection to the remote input of the FDPD4.

Discreet Power Harness Wiring. Connect the black wire of the power connector (shown on page 4) to a clean, bare-metal chassis ground. When in doubt, measure the resistance between potential grounding points and the vehicle battery using a multimeter. Choose a grounding point with equivalent resistance as other grounded components in the audio system. Connect the yellow wire to a constant +12V power source (vehicle battery). We DO NOT recommend the +12V constant in the factory radio harness due to the possibility of excessive voltage drop during vehicle starting. Connect the red wire to a +12V switched (ignition) power source. The red wire requires a 12V, 500 mA inline fuse; the yellow wire requires a +12V, 1 ampere fuse.
Note: Make sure that replacement fuses match this specification.

Once your SoundGate CORE is connected, use the table on Page 7 to determine what functions of the iPod device are controlled by the factory radio. Please note that the control of the device will differ depending upon which mode you have selected to emulate and replace: Rear-Seat DVD or Satellite. For more information on the CORE and other exciting products offered by SoundGate, please visit www.soundgate.com.

STEP

4

Mount all components. Mount the FDPD4 behind or under the dash (mounting hardware not included). Be careful not to drill into wiring or vehicle mechanisms. You are solely responsible for securely fastening the FDPD4 in your vehicle. Make certain that wires and cables cannot be damaged by screws, clips or sharp, exposed pieces of metal.

Ensure that the auxiliary inputs and CORE plug are in a convenient location for connection.

With the FDPD4 passing audio, test the auxiliary input by pressing the **AUX** button until you have selected the input source the FDPD4 is replacing.

Please note that the table on the following page is a generic control list. Your radio might not support all functions.

iPod Control

FORD	DVD EMULATION MODE	SAT EMULATION MODE
Disc ↑	Playlist ↑	Playlist ↑
Disc ↓	Playlist ↓	Playlist ↓
Seek ↑	Track ↑	Track ↑
Seek ↓	Track ↓	Track ↓
Repeat	Repeat	Repeat
Shuffle	Random	Random
Scan	Play/Pause	Play/Pause
FORD MP3	DVD EMULATION MODE	SAT EMULATION MODE
Disc ↑	Playlist ↑	Playlist ↑
Disc ↓	Playlist ↓	Playlist ↓
Seek ↑	Track ↑	Track ↑
Seek ↓	Track ↓	Track ↓
Repeat	-----	Repeat
Shuffle	Random	Random
Scan	Play/Pause	Play/Pause
Preset 3	-----	Repeat
FORD NAV	DVD EMULATION MODE	SAT EMULATION MODE
Tune ↑	-----	Playlist ↑
Tune ↓	-----	Playlist ↓
Seek ↑	Track ↑	Track ↑
Seek ↓	Track ↓	Track ↓
Touch Screen Forward arrow	Play/Pause	-----
Preset 3	-----	Repeat
Preset 4	-----	Play/Pause
Preset 5	-----	Random

Why SoundGate Dealers have the edge...

The technologies used in today's vehicles are as sophisticated as any laptop computer. At SoundGate we believe these new technologies are full of opportunities for mobile electronic dealers across the nation. We make it a high priority to not only research these new systems, but to understand them and their impact on the aftermarket car audio industry. Armed with this knowledge, we are well equipped to help you integrate new components into these systems with our innovative, high-performance interfaces and unparalleled technical support.

Be sure to ask your autosound specialist about these other exciting SoundGate products...

- Auxiliary Input Interfaces and Docking Stations which allow you to input audio from MP3 Players, DVD/Video, Satellite Radio, and more to OEM and aftermarket car audio systems
- High-performance Radio Replacement
- Interfaces for seamlessly integrating new receivers or CD players into OEM audio systems
- Competition-Grade Interfaces for adding amplifiers
- Remote Audio Control Interfaces that let you control aftermarket receivers and CD players from your factory rear seat, or steering-wheel mounted audio controls.
- And many others!

Simple-fi.®

www.soundgate.com

iPod is a trademark of Apple Computer, Inc., registered in the U.S. and other countries.

Copyright© 2004-2009 SoundGate®. All Rights Reserved. SoundGate® is a registered trademark of Stillwater Designs, Inc. All other trademarks are the property of their respective owners.